

EASY

EN

INSTALLATION
ENDLESS
INSPIRATION

AQFORM

LIGHTING SOLUTIONS

INSTALLATION
ENDLESS
INSPIRATION

Contents

HOLLOW GU10 recessed	p. 08
BLOS cast LED surface	p. 10
QRLED next surface	p. 12
PET GU10 surface	p. 14
VYRO x2 round move LED surface	p. 16
TRIBA midi 9 E27 suspended track	p. 18
Tracks	p. 20
Multitrack (48V)	p. 24
High Multitrack (48V)	p. 30
3F Track	p. 36
MROOM LED exterior table	p. 42
ONLY round mini LED 230V exterior surface	p. 44
VIP round LED 230V exterior wall	p. 46
VIP round up&down LED 230V exterior wall	p. 48





Hotel-T, Waregem
Photo: I am Liz

Easy-to-install fixtures

In our offer, you will find many fixtures that stand out for their easy installation. They successfully combine excellent technical parameters with modern design, effectively meeting the diverse needs of interiors.

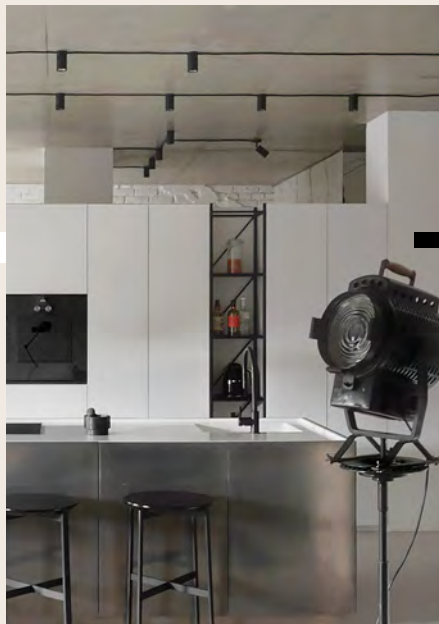

Private apartment, Krakow
Design: EFEM STUDIO | Photo: Filip Mienkina
Pet GU10 surface custom project

Quick Shipment

Fixtures needed right away? No problem! Check out our **Quick Shipment** offer, where you will find products available almost immediately! Thanks to optimized processes, fixtures are shipped in just 2-5 business days!

Check the available models and colours from the QS offer on our website (www.aqform.com/QS).

Our standard product range is shipped within 15-20 working days from the confirmed order.



Colours

Classic white & black, or perhaps intriguing terracotta or taupe? Our fixtures invite you to play with colours! In addition to the standard palette, upon request we are able to produce them in any shade from the RAL or NCS palette. Moreover, products that consists of multiple elements can be prepared in different colours.

Local production

We design, test, and manufacture our luminaires in our factory located near Krakow in southern Poland.

Our Research and Development Centre, dedicated to lighting, spans nearly 3,600 m². In 2024, we completed a new building with over 7,000 m² of warehouse and production space to enhance the efficiency of our production process.

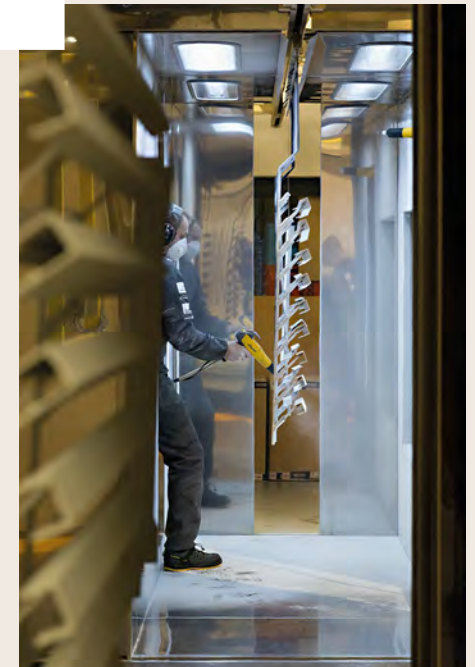

Practical information

Stylish & easy to install

This catalogue showcases a carefully selected range of modern, stylish luminaires designed for quick and easy installation—often taking just minutes for skilled hands. Convenient mounting saves time and effort, making life easier. This catalogue highlights a curated selection of products and their specifications. For more options, visit our website.

Essential tools for smooth installation

To help you achieve fastest results, we've included an overview of the tools that are most useful for mounting our luminaires. Having these essentials on hand ensures efficient and trouble-free installations.

- Hex screwdriver 1.5 + 2 + 2.5 *
- Small flathead screwdriver
- Small Phillips screwdriver
- Voltage tester
- Wire cutters
- Cordless drill, magnetic bit holder, Phillips bit
- Hammer drill, hammer drill bits
- Set of wall plugs



*preferably not in the L-shape

Icons legend

direction of light output

-  directional down
-  non-directional down
-  directional up&down
-  omni-directional

protection class

-  I class
-  II class
-  III class

ingress protection rating

-  IP65
-  IP20

-  non-integrated luminaire (e.g. E27)

-  mounting orientation

-  availability of control



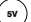



-  Colour Rendering Index

-  input voltage

-  mark for models, which extraordinarily help to control glare

-  impact protection rating

Finish

-  black - 12
-  white - 13
-  terracotta - 83
-  taupe - 82
-  multicolour - 06 - 06 - this finish allows to mix AQForm colours - including gold, grey, terracotta, taupe
-  mixes for some products

more finishes available on [our website](#)

WAZINE

Hollow

HOLLOW GU10 recessed

aqform.com/HL5033

power:	max: 50W
control:	Phase-Control (PH)

light source not included



colour	power	control	price	catalogue number
	50W ¹	Phase-Control ¹		
●			€ 27,75 ²	38054-0000-U8-PH-12
○				38054-0000-U8-PH-13

¹ the indicated parameters are common to all products below

Other variants are available on our website.

² gross price VAT excluded

Upon request, the fixture can be painted in any RAL or NCS colour.

A custom colour is available for order for a minimum amount of 500 EUR net.

Illustrative assembly method

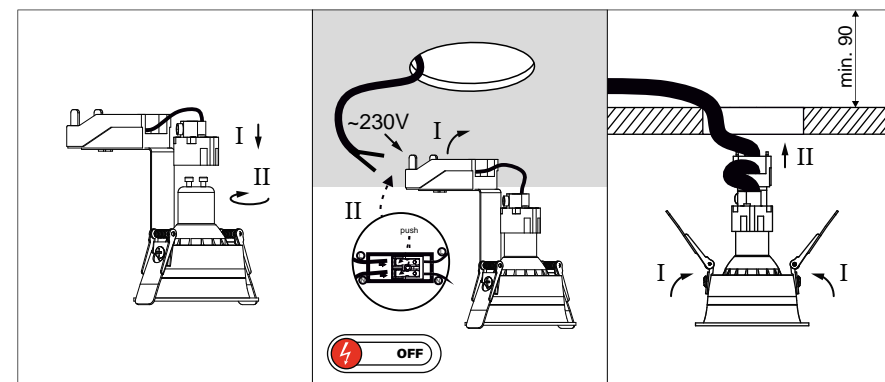
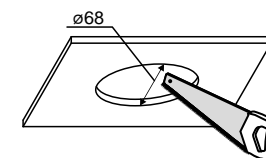

Blos

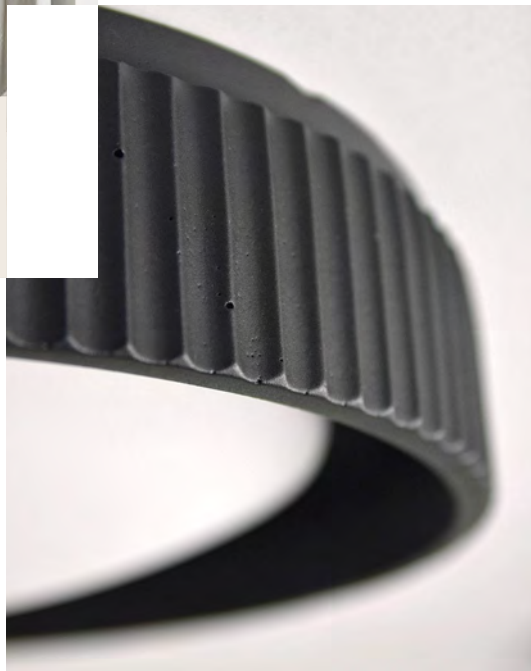

The BLOS cast lampshade, made from synthetic gypsum used in dentistry, features a distinctive porous texture with an industrial touch yet remains lightweight.

BLOS cast LED surface

power:	11.5W - 32.5W (M) ³
flux:	1030lm - 3130lm ³
CCT:	2700K (27) 3000K (30) 4000K (40)
control:	ON/OFF (00) DALI (DA)

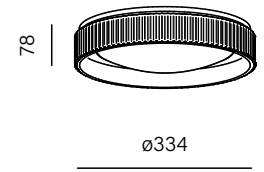

colour	power	flux	CCT	control	price	catalogue number
	11.5W ¹	1030lm ¹	2700K ¹	ON/OFF ¹		
●					€ 222,25 ²	47043-M927-D9-00-12
○						47043-M927-D9-00-13
●					€ 255,50 ²	47043-M927-D9-00-82
●						47043-M927-D9-00-83

¹ the indicated parameters are common to all products below

Other variants are available on our website.

² gross price VAT excluded | ³ higher power and flux are available for larger diameters (ø404, ø554)

Upon request, the fixture can be painted in any RAL or NCS colour.

A custom colour is available for order for a minimum amount of 500 EUR net.

Illustrative assembly method

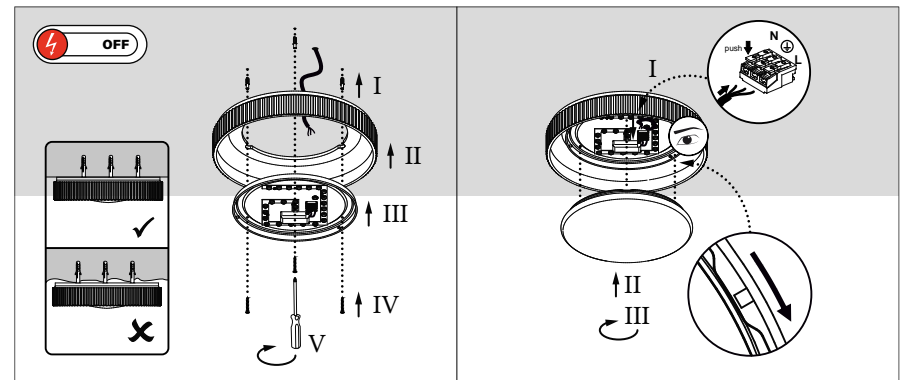

This product contains a light sources of energy efficiency class D.

The power and luminous flux are specified for the luminaire.

Qrled next

QRLED next surface

aqform.com/QR0014

power:	9W (L) 11W (M)
flux:	720lm - 1100lm
optics:	52° (W_)
CCT:	2700K (27) 3000K (30) 4000K (40)
control:	ON/OFF (00)

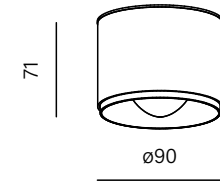

QRLED next surface | QRLED next move trim recessed

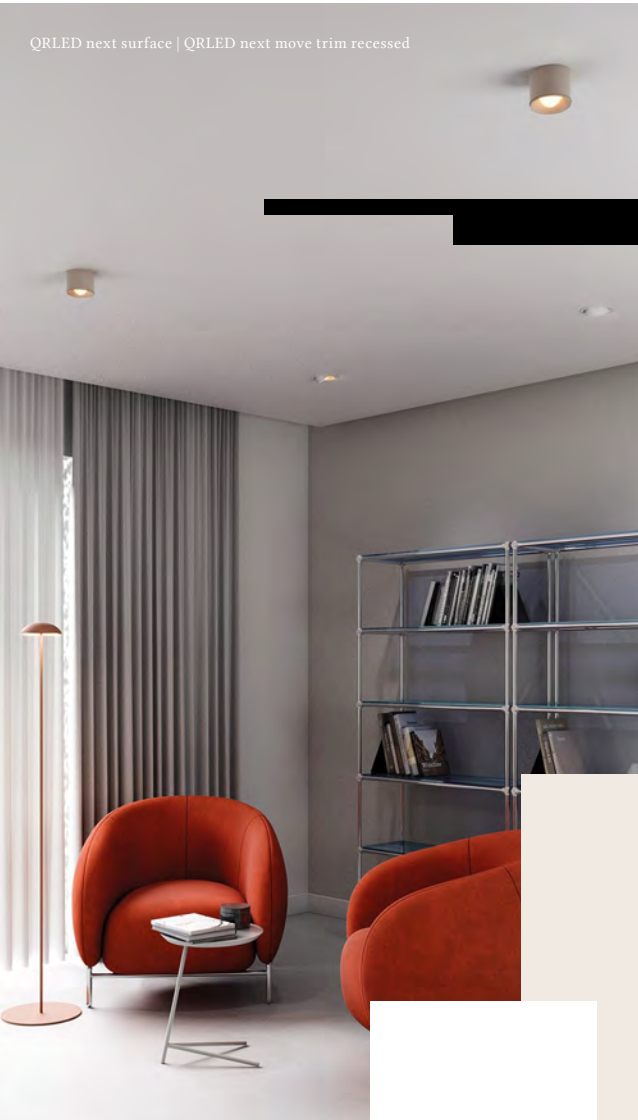

colour	power	flux	optics	CCT	control	price	catalogue number
	9W ¹	855lm ¹	52° ¹	2700K ¹	ON/OFF ¹		
●						€ 172,00 ²	47050-M927-W3-00-12
○							47050-M927-W3-00-13
●						€ 195,50 ²	47050-M927-W3-00-82
●							47050-M927-W3-00-83
●						€ 188,25 ²	47050-M927-W3-00-06 ³

¹ the indicated parameters are common to all products below

Other variants are available on our website.

² gross price VAT excluded | ³ on white and black luminaires the colour of the cover can be changed to gold, taupe, terracotta or gray colour from AQForm's palette

Upon request, the fixture can be painted in any RAL or NCS colour.
A custom colour is available for order for a minimum amount of 500 EUR net.

Illustrative assembly method

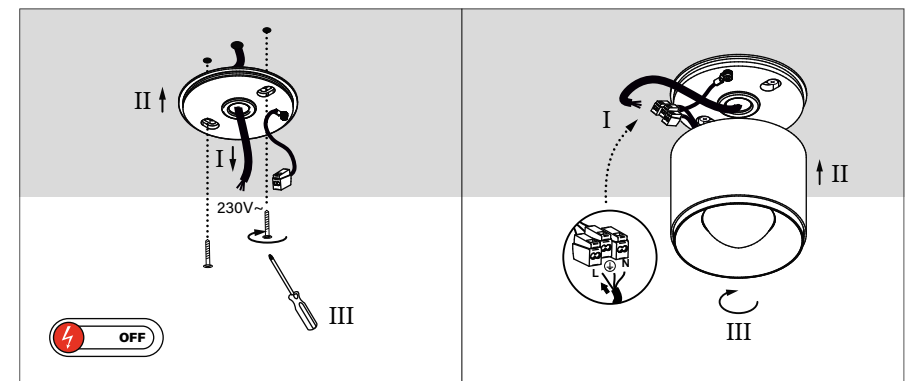

This product contains a light sources of energy efficiency class E.

The power and luminous flux are specified for the luminaire.

Pet



PET GU10 surface

aqform.com/PE9034

power:	max: 50W
control:	Phase-Control (PH)

light source not included

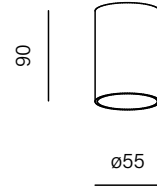

colour	power	control	price	catalogue number
	50W ¹	Phase-Control ¹		
●			€ 34,50 ²	QS ³ 42311-0000-U8-PH-12
○				QS ³ 42311-0000-U8-PH-13
●			€ 39,75 ²	42311-0000-U8-PH-82
●				42311-0000-U8-PH-83

¹ the indicated parameters are common to all products below

Other variants are available on our website.

² gross price VAT excluded | ³ shipment time up to 2-5 days

Upon request, the fixture can be painted in any RAL or NCS colour.
A custom colour is available for order for a minimum amount of 500 EUR net.



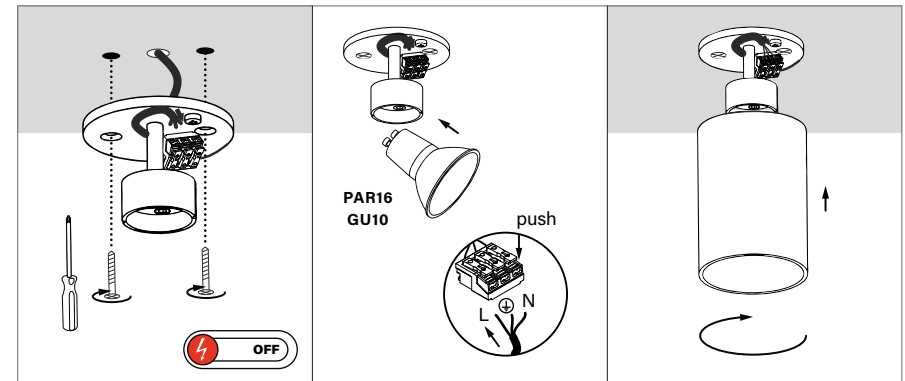



Illustrative assembly method



Vyro

VYRO x2 round move LED surface

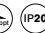
power:	14W (M)
flux:	1100lm - 1150lm
optics:	36° (F_) 59° (W_)
CCT:	2700K (27) 3000K (30)
control:	Phase-Control (PH) DALI (DA)

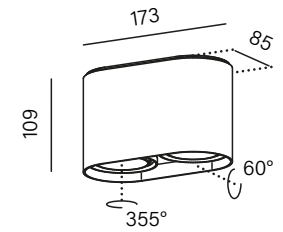

colour

body	optics	power	flux	optics	CCT	control	price	catalogue number
		14W ¹		36° ¹	2700K ¹	Phase-Control ¹		
●	●		1198lm				€ 273,00 ²	47038-M927-FB-PH-12
○	○		1290lm					QS ³ 47038-M927-FW-PH-13
●	●		1290lm				€ 314,00 ²	47038-M927-FT-PH-82
●	●		1290lm					47038-M927-FR-PH-83

¹ the indicated parameters are common to all products below

Other variants are available on our website.

² gross price VAT excluded | ³ shipment time up to 2-5 days

Upon request, the fixture can be painted in any RAL or NCS colour.
A custom colour is available for order for a minimum amount of 500 EUR net.

Illustrative assembly method

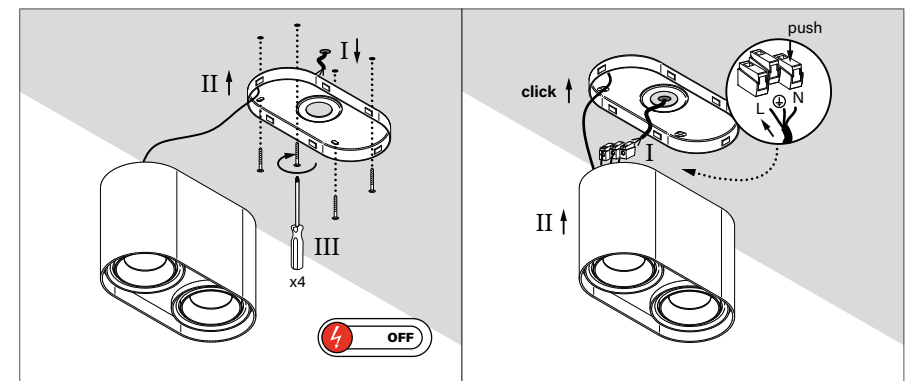

This product contains a light sources of energy efficiency class E.

The power and luminous flux are specified for the luminaire.

Triba E27

TRIBA midi 9 E27 suspended track

aqform.com/TR0026

power:	max: 50W
control:	Phase-Control (PH)

light source not included

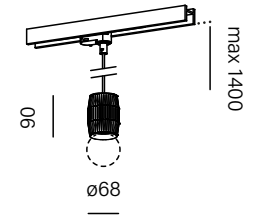

colour	power	control	price	catalogue number
	50W ¹	Phase-Control ¹		
●			€ 110,25 ²	16515-0000-U8-PH-12
○				16515-0000-U8-PH-13
●			€ 126,75 ²	16515-0000-U8-PH-82
●				16515-0000-U8-PH-83

¹ the indicated parameters are common to all products below

Other variants are available on our website.

²gross price VAT excluded

Upon request, the fixture can be painted in any RAL or NCS colour.
A custom colour is available for order for a minimum amount of 500 EUR net.

Illustrative assembly method

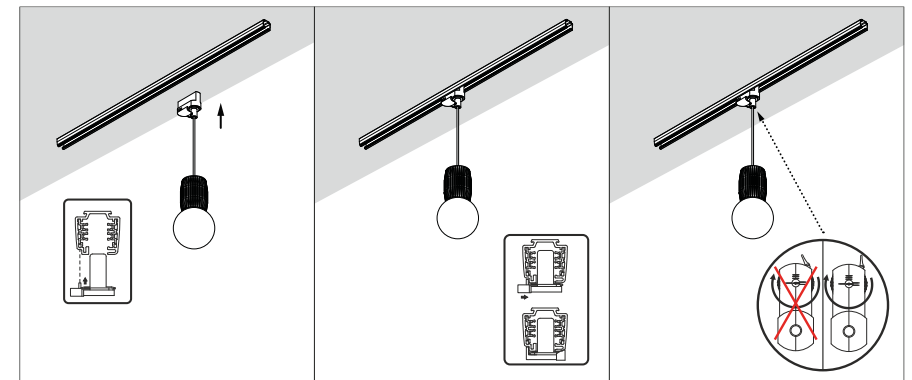

Design: Corona | Photo: I am Liz

La Muse de Marcel, Brugge

TRIBA midi E27 suspended track custom project

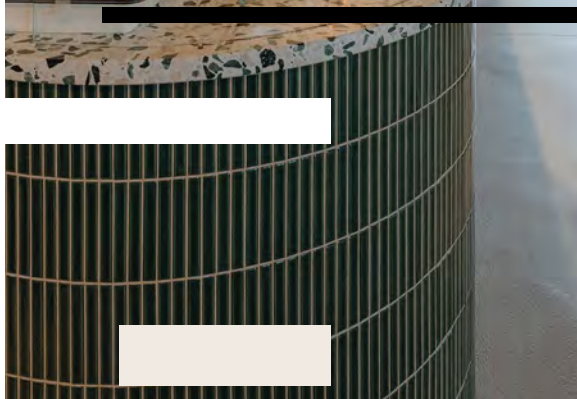

Tracks

Lighting tracks are very flexible solutions. Their main advantages are powering many luminaires from one point and the ability to easily change the arrangement and number of luminaires. They are perfect for shops, galleries and restaurants, but also for residential interiors.

MULTITRACK models are distinguished by their simple form and safe voltage of 48V inside the track. They can be mounted not only on the ceiling, but also on the wall, within easy reach.

MULTITRACK offers a surface-mounted version with a lower track height. It can be suspended. There is also a recessed variant. In both cases, the frame adapters are flush with the edge of the track. Higher versions: surface and trim or trimless recessed are solutions in which the linear fixtures are completely hidden within the track.

3F tracks are very popular and universal systems. They are available in a surface mounted version (including accessories for suspension), as well as a recessed. 3F tracks are also available in DALI version.

■ DOBRE
ROZWIĄZANIE





MULTITRACK

Safe voltage 48V & wall-ceiling arrangements

The safe voltage inside the MULTITRACK and variety of mechanical and electrical connectors allow to use the system within arm's reach and wall-ceiling transitions. The simple and refined form remains elegant even at very close proximity. In all MULTITRACK systems, luminaires can be connected to two circuits using two power supplies (except plug-in power supplies, which power only one circuit).

48V | max 2 metres in one piece | MULTITRACK is compatible with both ON-OFF (one or two circuits) and DALI. To create second circuits, use DALI wires as ON/OFF circuits 2 | Can be safely installed on walls | requires 48V power supply

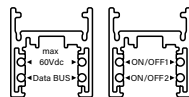

Easy to complete

The set can be designed in 4 simple steps

1. Select the track

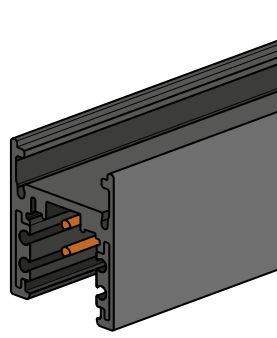
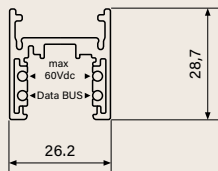

tracks	colour	catalogue number
surface 1000mm	black	SMCM1DAB
	white	SMCM1DAW
surface 2000mm	black	SMCM2DAB
	white	SMCM2DAW

Maximum load

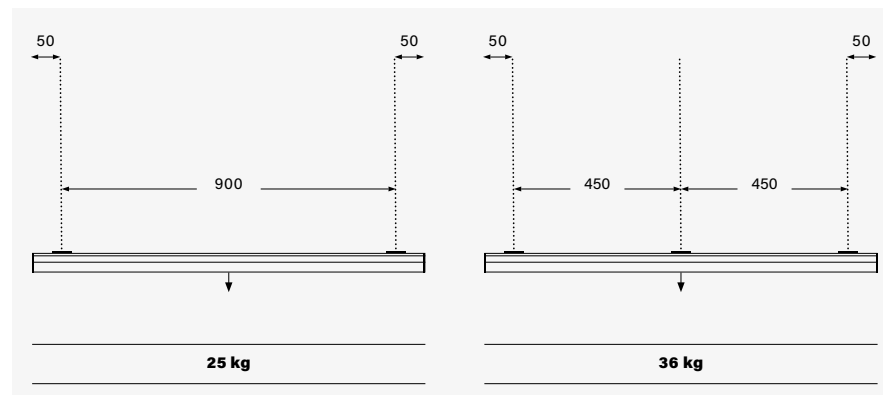

2. Choose the appropriate connector

product	colour	catalogue number
M MULTITRACK straight connector		SMCSU000
M MULTITRACK electrical straight connector universal	black	SMASUDAB
	white	SMASUDAW

product	colour	catalogue number
M MULTITRACK mechanical connector „L” surface/suspended	black	SMCLU00B
	white	SMCLU00W
M MULTITRACK electrical connector „L” universal	black	SMPLUDAB
	white	SMPLUDAW

product	colour	catalogue number
M MULTITRACK electrical flexible connector universal	black	SMPFUDAB
	white	SMPFUDAW

3. Select the power supply method

1. Plug-in driver (drivers mounted within the track):

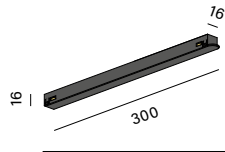

product	colour	catalogue number
M MULTITRACK power supply plug-in 100W 48V	black	SHIP010W
	white	SHIP010B

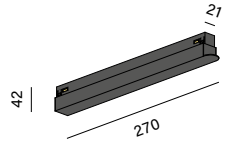

product	colour	catalogue number
M MULTITRACK power supply plug-in 250W 48V	black	SHIP025B
	white	SHIP025W

Plug-in 250W sticks out from the MULTITRACK surface

2. Driver:



product	catalogue number
power supply 60W 48V	SHRP0600
power supply 100W 48V	SHRP0100
power supply 200W 48V	SHRP0200

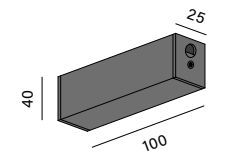

product	colour	catalogue number
M MULTITRACK canopy surface	black	SMCB200B
	white	SMCB200W

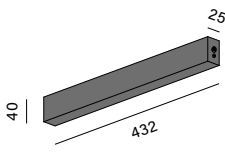

product	colour	catalogue number
M MULTITRACK canopy with power supply EM 100W 48V surface	black	SMCMMPBB
	white	SMCMMPBW

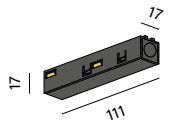

product	colour	catalogue number
M MULTITRACK power feed universal	black	SMPCUDAB
	white	SMPCUDAW

4. Match the remaining components: end caps, mounting elements, and other



product	colour	catalogue number
M MULTITRACK end cap surface/suspended	black	SMECU00B
	white	SMECU00W



product	colour	catalogue number
M MULTITRACK end cap with opening surface/suspended	black	SMECH00B
	white	SMECH00W

product	catalogue number
ADDITIONAL OPENING FOR power feed	810320

Extra

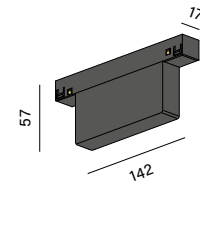

product	colour	catalogue number
M MULTITRACK AQsmart interface adapter	black	SMAMUDBB
	white	SMAMUDBW

Multitrack system can be controlled wirelessly. For wireless control AQsmart module is needed for each group of luminaires connected to the track. Regardless of AQsmart module, the luminaire must be in the DALI version. One device can control up to 64 fixtures, which can be divided into a maximum of 8 groups.



Example of track set

Multitrack surface

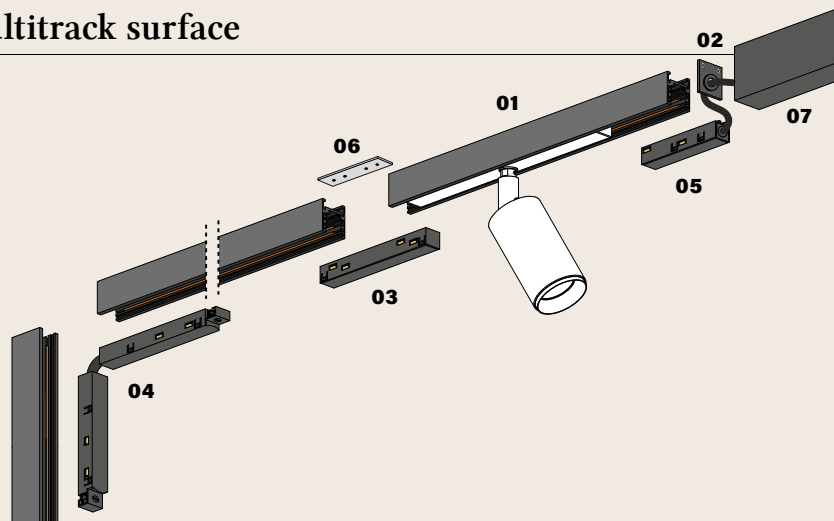

	product	catalogue number
01	M MULTITRACK profile surface black	SMCM_*DAB
02	M MULTITRACK end cap with opening surface/suspended black	SMECH00B
03	M MULTITRACK electrical straight connector universal black	SMECH00B
04	M MULTITRACK electrical flexible connector universal black	SMPFUDAB
05	M MULTITRACK power feed universal black	SMPCUDAB
06	M MULTITRACK straight connector	SMCSU000
07	M MULTITRACK canopy with power supply EM 100W 48V surface black	SMCMMPBB

TIP: within one track part of luminaires can be on while other stay off at the same time!

Within one MULTITRACK, it is possible to connect luminaires for two circuits, provided that two power supplies are used. In order for the fittings to operate on two circuits, some luminaires need to be selected with the control: ON/OFF - the second circuit.



HIGH MULTITRACK

Multitrack features + more space

A greater track height means more concealed mounting elements. In the HIGH MULTITRACK system, the mounting component of most luminaires is completely hidden from view, and some luminaires allow the entire lighting element to be flush with the ceiling.

48V | max 3 metres in one piece | ON-OFF (one or two circuits) | DALI
Can be safely installed on walls | requires 48V power supply

Easy to complete

The set can be designed in 4 simple steps

1. Select the track

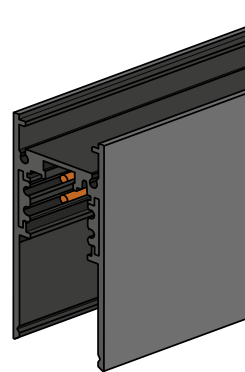
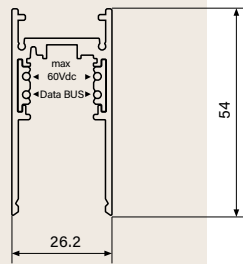

tracks	colour	catalogue number
surface 1000mm	black	SHCM1DAB
	white	SHCM1DAW
surface 2000mm	black	SHCM2DAB
	white	SHCM2DAW
surface 3000mm	black	SHCM3DAB
	white	SHCM3DAW

Maximum load

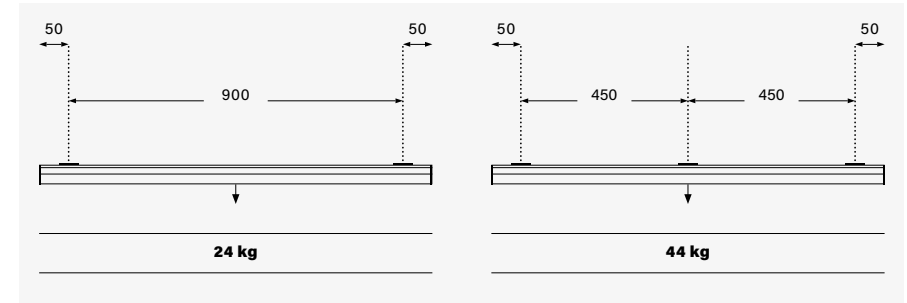

2. Choose the appropriate connector

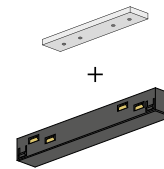

product	colour	catalogue number
M MULTITRACK straight connector		SMCSU000
M MULTITRACK electrical straight connector universal	black	SMASUDAB
	white	SMASUDAW

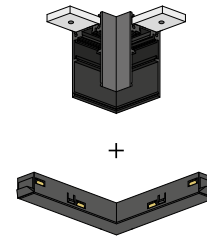

product	colour	catalogue number
M HIGH MULTITRACK mechanical connector „L” surface	black	SHCLU00B
	white	SHCLU00W
M MULTITRACK electrical connector „L” universal	black	SAMPLUDAB
	white	SAMPLUDAW

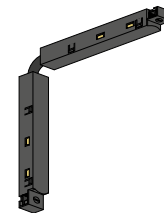

product	colour	catalogue number
M MULTITRACK electrical flexible connector universal	black	SMPFUDAB
	white	SMPFUDAW

3. Select the power supply method

1. Plug-in driver (drivers mounted within the track):

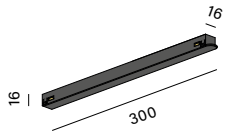

product	colour	catalogue number
M MULTITRACK power supply plug-in 100W 48V	black	SHIP010W
	white	SHIP010B

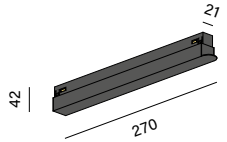

product	colour	catalogue number
M MULTITRACK power supply plug-in 250W 48V	black	SHIP025B
	white	SHIP025W

2. Driver:

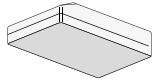

product	catalogue number
power supply 60W 48V	SHRP0600
power supply 100W 48V	SHRP0100
power supply 200W 48V	SHRP0200

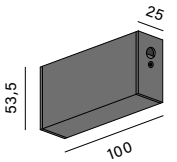

product	colour	catalogue number
M HIGH MULTITRACK canopy surface	black	SHCB200B
	white	SHCB200W

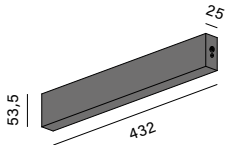

product	colour	catalogue number
M HIGH MULTITRACK power supply canopy 100W 48V surface	black	SHCP2PBB
	white	SHCP2PBW

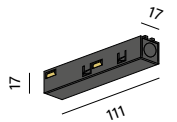

product	colour	catalogue number
M MULTITRACK power feed universal	black	SMPCUDAB
	white	SMPCUDAW

4. Match the remaining components: end caps, mounting elements, and other



product	colour	catalogue number
M HIGH MULTITRACK end cap	black	SHECU00B
	white	SHECU00W



product	colour	catalogue number
M HIGH MULTITRACK end cap with opening	black	SHECH00B
	white	SHECH00W

product	catalogue number
ADDITIONAL OPENING FOR power feed	810320

Extra

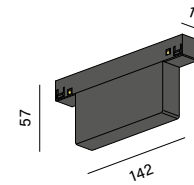

product	colour	catalogue number
M MULTITRACK AQsmart interface adapter	black	SMAMUDBB
	white	SMAMUDBW

Multitrack system can be controlled wirelessly. For wireless control AQsmart module is needed for each group of luminaires connected to the track. Regardless of AQsmart module, the luminaire must be in the DALI version. One device can control up to 64 fixtures, which can be divided into a maximum of 8 groups.



Example of track set

High Multitrack surface

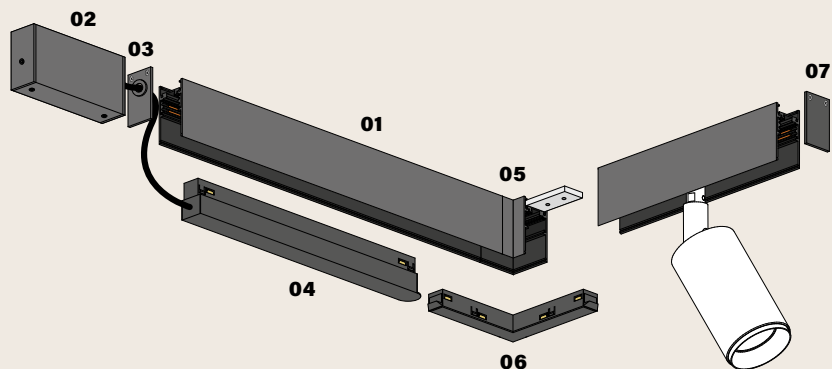

	product	catalogue number
01	M HIGH MULTITRACK profile surface black	SHCM_*DAB
02	M HIGH MULTITRACK canopy surface black	SHCB200B
03	M HIGH MULTITRACK end cap with opening black	SHECH00B
04	M MULTITRACK power supply plug-in 250W 48V black	SHIP025B
05	M HIGH MULTITRACK mechanical connector „L” surface black	SHCLU00B
06	M MULTITRACK connector „L” electrical universal black	SMPLUDAB
07	M HIGH MULTITRACK end cap black	SHECU00B



3F TRACK

With the use of track systems, one can easily change the number, location and even the type of luminaires installed indoors. It is possible to adjust the interior lighting without making additional changes to the ceiling structure or electrical installation. Track systems are made of aluminum profiles varnished in selected colours. The inside copper wires are placed in a guideway made of self-extinguishing polycarbonate, which also insulates the wires from the aluminium body. Fire resistance class – V-0.

The track can be cut to given dimensions at the installation site. The cut surface or copper line of standard 3F tracks does not require bending or any other special treatment after the cut. Copper lines of the 3F DALI track need to be trimmed after the cut.

230V | max 3 metres in one piece | ON-OFF (three circuits) | DALI

Easy to complete

The set can be designed in 4 simple steps

1. Select the track

ON/OFF

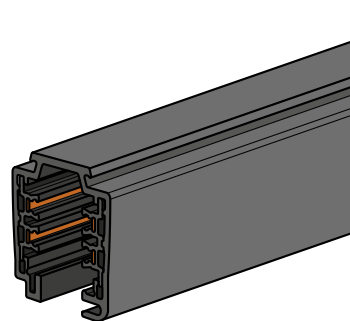
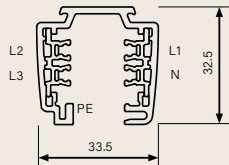

tracks	colour	catalogue number
surface/suspended 1000mm	black	STCH1PHB
	white	STCH1PHW
surface/suspended 2000mm	black	STCH2PHB
	white	STCH2PHW
surface/suspended 3000mm	black	STCH3PHB
	white	STCH3PHW

DALI

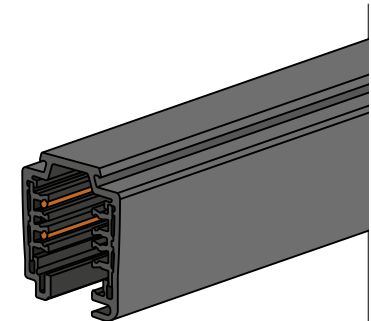
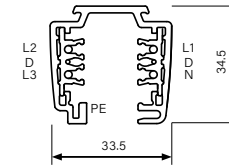

tracks	colour	catalogue number
DALI surface/suspended 2000mm	black	STCH2DAB
	white	STCH2DAW
DALI surface/suspended 3000mm	black	STCH3DAB
	white	STCH3DAW

2. Choose the appropriate connector + the power supply method

		product	colour	catalogue number
		LU TRACK 3F power feed (A)	black	STPCLPHB
			white	STPCLPHW
	L R	LU TRACK 3F power feed (B)	black	STPCRPHB
			white	STPCRPHW
	PH DA	LU TRACK DALI power feed (A)	black	STPCLDAB
			white	STPCLDAW
		LU TRACK DALI power feed (B)	black	STPCRDAB
			white	STPCRDAW
	67 92			

		product	colour	catalogue number
		LU TRACK 3F straight connector	black	STASUPHB
			white	STASUPHW
		LU TRACK DALI straight connector	black	STASUDAB
			white	STASUDAW
	PH DA			
	100 151			

		product	catalogue number
		LU TRACK 3F universal internal jointing unit	STAIUPHU
		LU TRACK DALI universal internal jointing unit	STAIUDAU

		product	colour	catalogue number
		LU TRACK 3F connector „T“ (A)	black	STATAPHB
			white	STATAPHW
		LU TRACK 3F connector „T“ (B)	black	STATBPHB
			white	STATBPHW
		LU TRACK 3F connector „T“ (C)	black	STATCPHB
			white	STATCPHW
		LU TRACK 3F connector „T“ (D)	black	STATDPHB
			white	STATDPHW
		LU TRACK DALI connector „T“ (A)	black	STATADAB
			white	STATADAW

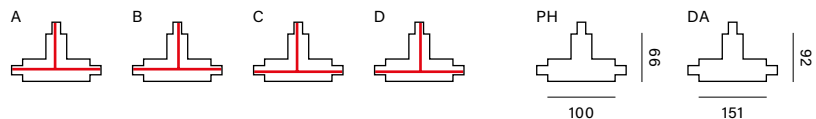

		product	colour	catalogue number
		LU TRACK 3F connector „L“ universal	black	STALUPHB
			white	STALUPHW
		LU TRACK DALI connector „L“ universal	black	STALUDAB
			white	STALUDAW
	PH DA			
	66 92			

		product	colour	catalogue number
		LU TRACK 3F connector „X“	black	STAXUPHB
			white	STAXUPHW
	100			

		product	colour	catalogue number
		LU TRACK 3F adjustable connector	black	STAFUPHB
			white	STAFUPHW

		product	colour	catalogue number
		LU TRACK 3F power outlet adapter	black	STAPUPHB
			white	STAPUPHW

3. Match the remaining components: end caps, mounting elements, and other

		product	colour	catalogue number
		LU TRACK 3F end cap	black	STECUPHB
			white	STECUPHW
		LU TRACK DALI end cap	black	STECUDAB
			white	STECUDAW

power supply possibility + placement of grounding elements

Example of track set

3F track DALI surface

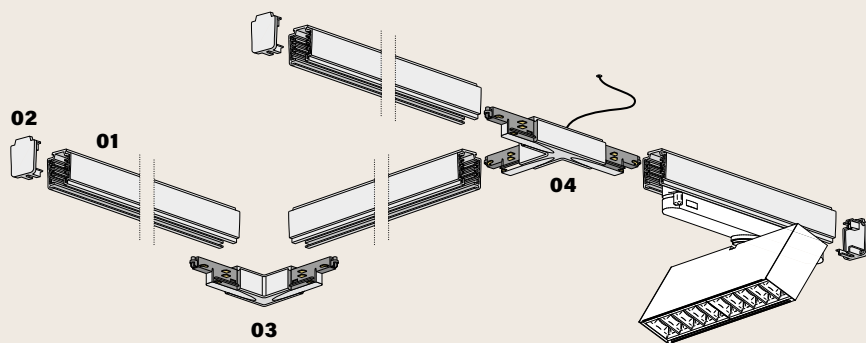

	product	catalogue number
01	LU TRACK DALI profile surface white	STCH_*DHW
02	LU TRACK DALI end cap white	STECUPHW
03	LU TRACK DALI connector „L” universal white	STALUDAW
04	LU TRACK DALI connector „T” (A) white	STATADAW



Mroom

MROOM LED exterior table



MROOM LED exterior table

aqform.com/MM0010

power:	4W (M)
flux:	410lm - 450lm
CCT:	2700K (27) 3000K (30)
control:	touchDIM (TD)

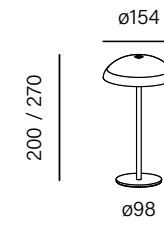

colour	power	flux	CCT	control	price	catalogue number
	4W ¹	410lm ¹	2700K ¹	touchDIM ¹		
●					€ 210,00 ²	26576-M927-D9-TD-12
○						26576-M927-D9-TD-13
●					€ 241,50 ²	26576-M927-D9-TD-82
●						26576-M927-D9-TD-83

¹ the indicated parameters are common to all products below

Other variants are available on our website.

² gross price VAT excluded

Wireless luminaire with a built-in battery, charged via USB-C. Battery capacity 5000mAh. The luminaire has touch control: on/off and smooth power adjustment.

MROOM LED upright
aqform.com/MM1010

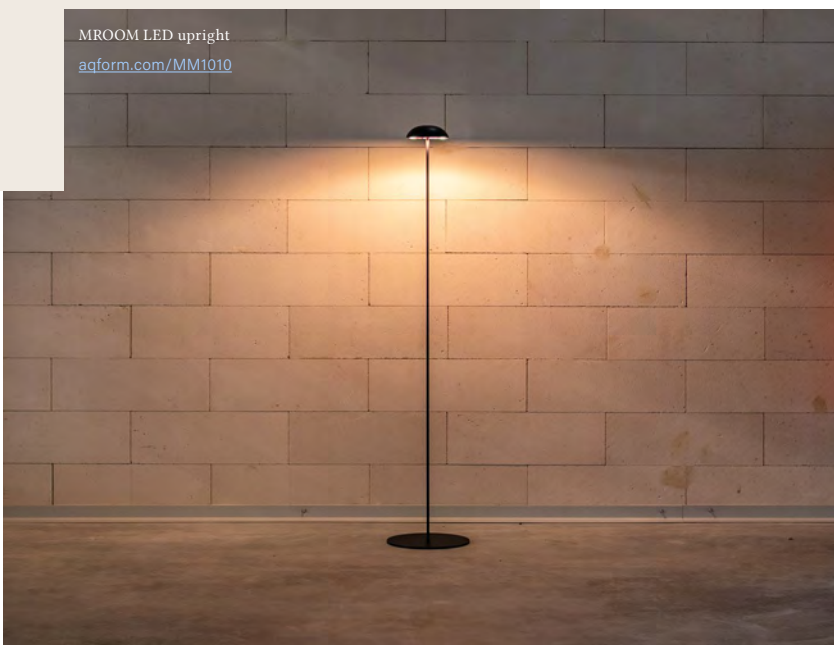

Illustrative assembly method

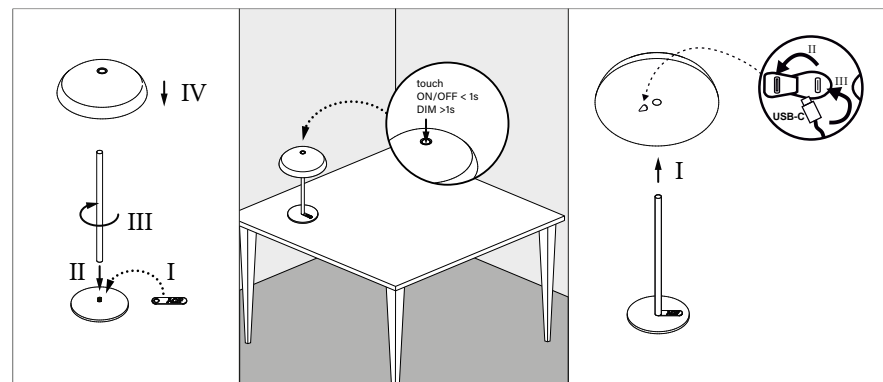

This product contains a light sources of energy efficiency class E.

The power and luminous flux are specified for the luminaire.

ONLY round mini



ONLY round mini LED 230V exterior surface



ONLY round mini LED 230V exterior surface aqform.com/ON1974

power:	8W (M)
flux:	460lm - 590lm
optics:	26° (F_) 40° (W_) opal (D9)
CCT:	2700K (27) 3000K (30) 4000K (40)
control:	Phase-Control (PH)

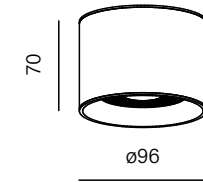

colour	power	flux	optics	CCT	control	price	catalogue number
	8W ¹	540lm ¹	40° ¹	2700K ¹	Phase-Control ¹		
●						€ 144,25 ²	47018-M927-W3-PH-12
○							47018-M927-W3-PH-13
● ³						€ 166,00 ²	47018-M927-W3-PH-82
● ³							47018-M927-W3-PH-83

¹ the indicated parameters are common to all products below

Other variants are available on our website.

² gross price VAT excluded

³ taupe and terracotta finish can only be used indoors

Illustrative assembly method

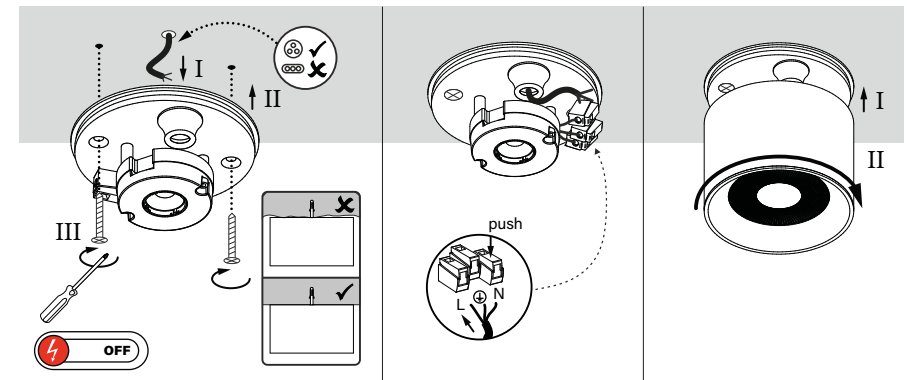

This product contains a light sources of energy efficiency class F.

The power and luminous flux are specified for the luminaire.

Vip round

VIP round LED 230V exterior wall

aqform.com/VP1912

power:	6W (M)
flux:	230lm - 320lm
optics:	64° (W_) 71° (W_)
CCT:	2700K (27) 3000K (30)
control:	Phase-Control (PH)

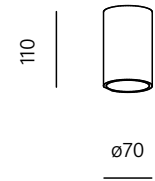

colour

body	optics	power	flux	optics	CCT	control	price	catalogue number
		6W ¹			2700K ¹	Phase-Control ¹		
●	●		230lm	64°			€ 215,25 ²	26540-M927-WB-PH-12
○	○		310lm	71°				26540-M927-WW-PH-13

¹ the indicated parameters are common to all products below

Other variants are available on our website.

² gross price VAT excluded

Illustrative assembly method

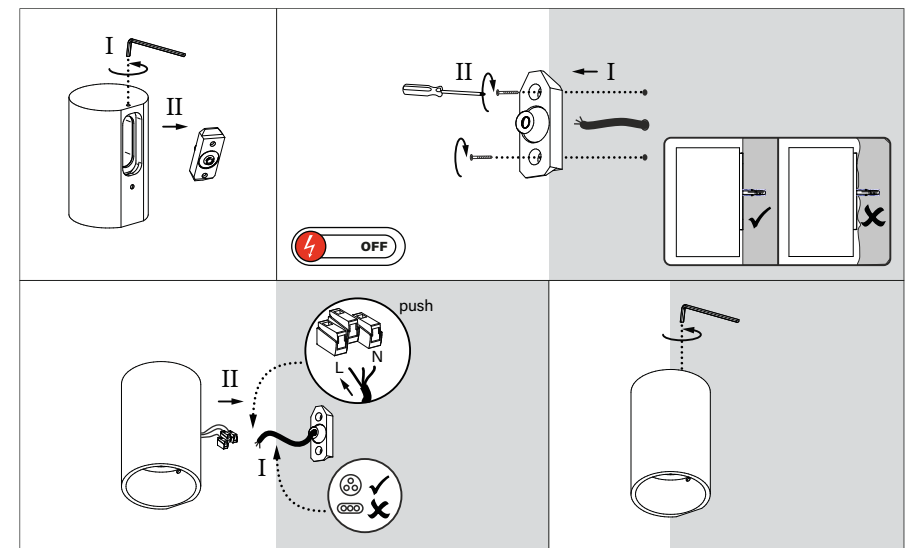

This product contains a light sources of energy efficiency class F.

The power and luminous flux are specified for the luminaire.

VIP round LED 230V exterior wall

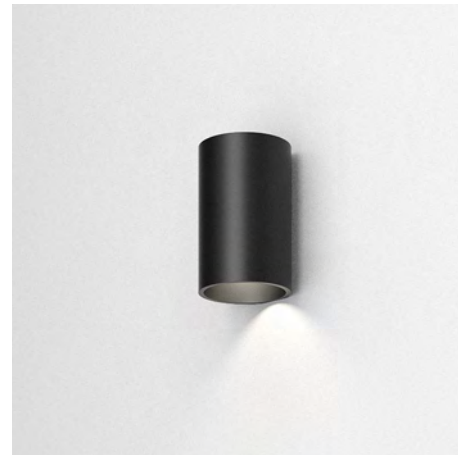

Vip round up&down



VIP round up&down LED 230V exterior wall



VIP round up&down LED 230V exterior wall

aqform.com/VP2912

power:	12W (M)
flux:	430lm - 650lm
optics:	64° (W_) 71° (W_)
CCT:	2700K (27) 3000K (30)
control:	Phase-Control (PH)

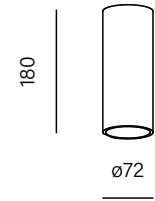

colour

body	optics	power	flux	optics	CCT	control	price	catalogue number
		12W ¹			2700K ¹	Phase-Control ¹		
●	●		430lm	64°			€ 236,75 ²	QS ³ 26541-M927-WB-PH-12
○	○		620lm	71°				26541-M927-WW-PH-13

¹ the indicated parameters are common to all products below

Other variants are available on our website.

² gross price VAT excluded | ³ shipment time up to 2-5 days

Illustrative assembly method

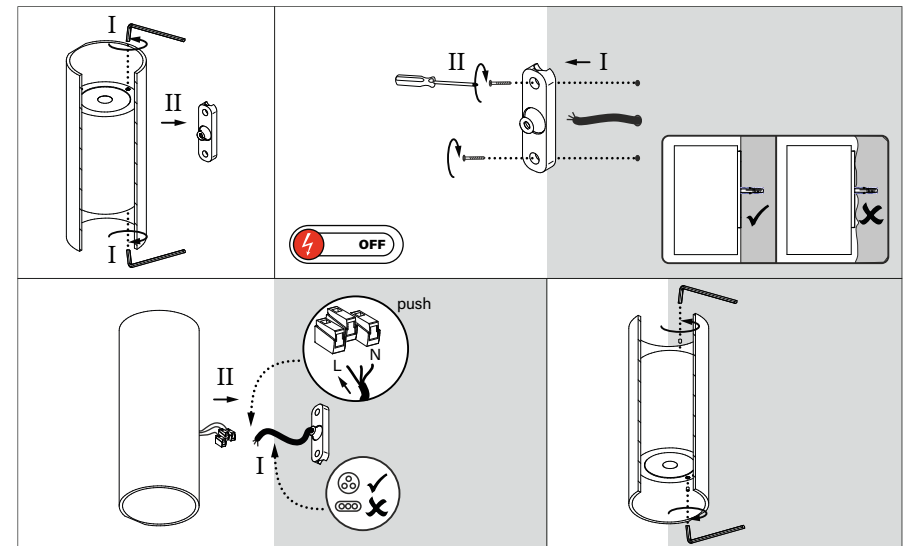

This product contains a light sources of energy efficiency class F.

The power and luminous flux are specified for the luminaire.



PART OF

DELTA LIGHT Group



All dimensions and technical data in catalogues are provided for a guidance purposes only. Actual data may differ slightly due to the production process. Technical information contained within Aquaform's website, data sheets or mounting instructions shall prevail over the information contained in catalogues. Aquaform Inc. reserves the right to change the presented materials and product specifications without prior notice.

Aquaform Inc. takes no responsibility for any possible misprints. All photos, icons and images are copyright protected. Images are illustrative presentations of products and colours. Due to the production process RAL colour of white track and adapter differs a few tones from a standard white finish of AQForm luminaires.

Information contained in the catalogue shall not constitute an offer, also within the meaning of art. 66 § 1 of Polish Civil Code.

© 2025 AQUAFORM Inc. sp. z o.o.
All rights reserved.

All prices are suggested retail prices without tax. Prices are subject to change without prior notice. The prices are provide for informative purposes only and shall not constitute an offer, also within the meaning of Art. 66 § 1 of the Polish Civil Code.

Luminaires do not contain light sources, except for LED luminaires with an integrated light source.



IDEALNIE

EASY
INSTALLATION

INSTALLATION

ENDLESS
INSPIRATION

www.aqform.com

INSPIRATION